POCKET GUIDE



LITTLE ROCK
ARKANSAS

DEC. 7-9, 2008



**USA RICE
OUTLOOK
CONFERENCE**

Educational Service of the
USA Rice Federation

Welcome to the USA Rice Outlook Conference

The annual USA Rice Outlook Conference provides a forum for all segments of the U.S. rice industry to examine timely and important issues. The goal of this conference is to advance industry education, communication, understanding and cooperation. Thank you for attending and taking part in this effort.



James Warshaw
Chairman
USA Rice Federation

Betsy Ward
President and CEO
USA Rice
Federation

Mike Sandrock
Chairman
USA Rice
Millers' Association

Clarence Berken
Chairman
USA Rice Council

Thomas Hoskyn
Chairman
USA Rice Producers'
Group

Brian King
Chairman
USA Rice Merchants'
Association

CONFERENCE REGISTRATION HOURS:

(Toltec Registration Desk, Statehouse Convention Center)

Saturday, December 6

1 p.m. to 5 p.m.

Sunday, December 7

7:30 a.m. to 5:30 p.m.

Monday, December 8

7:15 a.m. to 6:00 p.m.

Tuesday, December 9

7:30 a.m. to 11:00 a.m.

2008 USA RICE OUTLOOK CONFERENCE

Registration Hours.....	Inside Front Cover
Conference Planning Subcommittee	2
2008 Sponsors.....	3-4
You're Invited	5
2008 Exhibitors	6-7
Conference Program	8-18
Platinum and Silver Sponsor Recognition	19-24
Program Schedule-at-a-Glance	Back Cover

2008 USA RICE OUTLOOK CONFERENCE PLANNING SUBCOMMITTEE

Chairman Jennifer James

Producer, Arkansas

Jeremy Baltz

Producer, Arkansas

Joe Carraway

Riceland Foods, Inc.

Bobby Coats

University of Arkansas Extension

Chris Crutchfield

Great Western Growers

Michael Cureton

Producer, Arkansas

Chad Duckworth

RiceTec, Inc.

Larry Falconer

Texas A&M University Extension

Chris Greer

University of California Extension

Bobby Hanks

Louisiana Rice Mill, Inc.

Mindy Hetzel

Producer, Louisiana

Bobby Hoard

Producer, Arkansas

Gene Johnson

Louisiana State University Extension

Traci LaChance

Garrett Seed Rice, LTD

Heath Long

Producer, Arkansas

Dick Ottis

Rice Belt Warehouse, Inc.

David Petter

Producer, Arkansas

Bill Reed

Riceland Foods, Inc.

Thomas Tangaro

Anheuser-Busch, Inc.

Timothy Walker

Mississippi State University Extension

Dean Wall

Producer, Arkansas

Drew Whiting

Producer, Arkansas

Ex Officio

James Warshaw

Chairman, USA Rice Federation

SPECIAL THANKS TO OUR CONFERENCE SPONSORS

PLATINUM SPONSORS

Anheuser-Busch, Inc.

Beer for Grand Opening Reception and
USA Rice Outlook Conference Annual Reception

Bayer CropScience

General Conference Sponsor

Dow AgroSciences

Annual Conference Reception

Farm Press

Official Publication Sponsor
Host of New Products and Technology Showcase

SILVER SPONSORS

AgHeritage Farm Credit Services & Farm Credit Midsouth

Grand Opening Reception

AGROTAIN International

Grand Opening Reception

John Deere Company

Annual Awards Luncheon

KBX, Inc.

Grand Opening Reception

Syngenta

Annual Awards Luncheon

Valmont Irrigation

Conference Tote Bags

BRONZE SPONSORS

CASE IH

Monday Afternoon Coffee and Beverage Break

FMC Corporation

Tuesday Morning Coffee and Beverage Service

Food Protection Services

New Products and Technology Showcase Coffee and Beverage Service

Rice Belt Warehouse Inc.

Monday Morning Coffee and Beverage Break

RiceTec, Inc.

Conference Lanyards

Trinidad Benham Corporation

Tuesday Morning Continental Breakfast

PATRON SPONSOR

BASF Corporation

General Conference Sponsor

DuPont Crop Protection

General Conference Sponsor

Kellogg Company

General Conference Sponsor

RiceCo, LLC

General Conference Sponsor

The generous support of the 2008 USA Rice Outlook Conference sponsors helps make this event a success. Please join us in thanking all of this year's sponsoring companies.

YOU'RE INVITED

Check the schedule and for these and other important activities. The USA Rice Outlook Conference will be held at the Statehouse Convention Center, adjacent to the Peabody Little Rock Hotel.

Sunday Evening **GRAND OPENING RECEPTION**

Governor's Hall IV – Exhibit Hall

Monday Morning **NEW PRODUCTS AND TECHNOLOGY SHOWCASE**

Governor's Hall IV – Exhibit Hall

Monday Luncheon **RICE AWARDS**

Statehouse Ballroom

Monday Evening **ANNUAL CONFERENCE RECEPTION**

Governor's Hall IV – Exhibit Hall

SPECIAL THANKS to Stewart Doan, Senior Editor at Agri-Pulse Communications, Inc., for serving as moderator at the 2008 USA Rice Outlook Conference.

2008 USA RICE OUTLOOK CONFERENCE EXHIBIT BOOTHS

Thank you to our exhibitors for their participation.

Booth #	Company Name
2a.....	AGROTAIN International
28 & 29	Alliance Application Equipment
16	ARKLA Equipment Sales
38	Arkansas Rice Depot
39	Arkansas Agricultural Department
40	Arkansas Rice Council
32 & 33.....	Cache River Valley Seed
1 & 2.....	Case IH
3	CME Group
8	Custom Marketing Co., Inc.
30	Delta Plastics
6	Dow AgroSciences, LLC
14	Ducks Unlimited, Inc.
25	DuPont Crop Protection
4	Eurofin Genescene
26	Farm Press
23	Farm Works Software
20	FMC Corporation
5	Food Protection Service
11 & 12.....	GeoShack
34	Horizon Ag, LLC
5a.....	Hurt Enterprises
7	John Deere Company
24	Kellogg Company
19	Class Lexion Combine
9	Nature Safe Natural & Organic Fertilizers
30a.....	Rabo AgriFinance
35	Rice Belt Warehouse Inc.
17	RiceCo, LLC
15	Rice Online.com
21 & 22.....	RiceTec, Inc.
13	Shanzer Dryer
34a.....	The Scoular Company
36 & 37.....	USA Rice Federation
18	USDA/NASS
10	Valley View Agri
27	Valmont Irrigation
31	White River Irrigation District

Exhibit Hours:

Sunday, Dec. 7	5:30 p.m. – 6:30 p.m.
Monday, Dec. 8	7:15 a.m. – 7 p.m.
Tuesday, Dec. 9	7:30 a.m. – 11 a.m.

EXHIBIT BOOTH DIAGRAM

Governor's IV

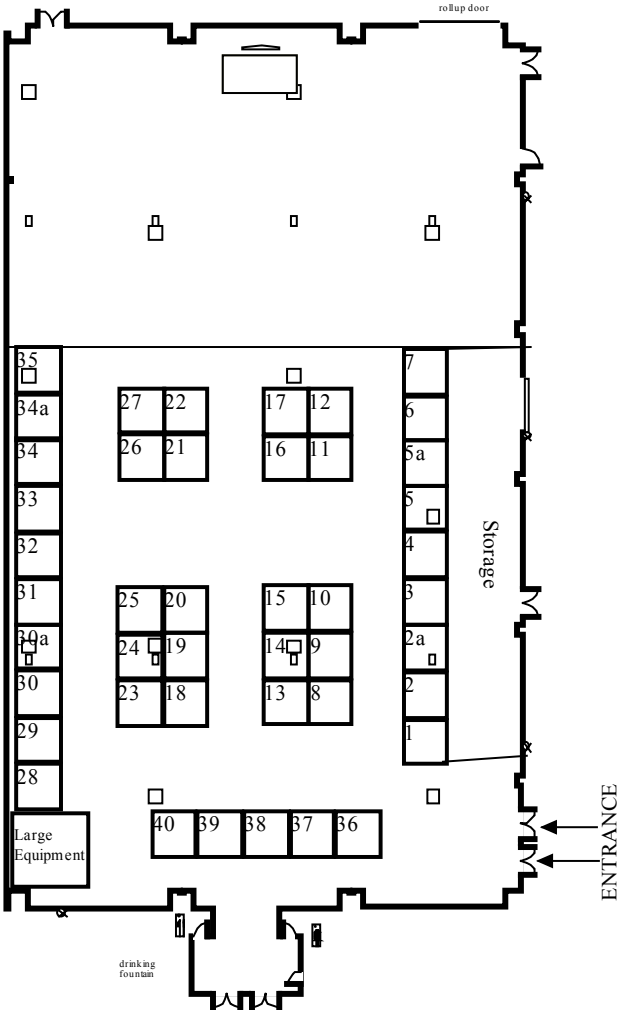

2008 USA RICE OUTLOOK CONFERENCE PROGRAM

SATURDAY, DECEMBER 6, 2008

1 p.m. to 5 p.m.

REGISTRATION

Toltec Registration Desk
Statehouse Convention Center

SUNDAY, DECEMBER 7, 2008

7:30 a.m. to 5:30 p.m.

REGISTRATION

Toltec Registration Desk
Statehouse Convention Center

2:00 p.m. to 4:30 p.m.

GUEST EVENT: Rice "VIP" Culinary Event at the Historic Capital Hotel (meet in Peabody lobby at 1:45 p.m.)

5:30 p.m. to 6:30 p.m.

GRAND OPENING RECEPTION

Governor's Hall IV — Exhibit Hall
Statehouse Convention Center

Platinum Sponsor:

Anheuser-Busch, Inc.

Silver Sponsors:

AgHeritage Farm Credit Services
& Farm Credit Midsouth
AGROTAIN International
KBX, Inc.

MONDAY, DECEMBER 8, 2008

7:15 a.m. to 6 p.m.

REGISTRATION

Toltec Registration Desk
Statehouse Convention Center

7:15 a.m.

EXHIBIT HALL OPENS

Governor's Hall IV — Exhibit Hall
Statehouse Convention Center

MONDAY, DECEMBER 8, 2008 continued

7:30 a.m. to 8:55 a.m.

**NEW PRODUCTS AND TECHNOLOGY
SESSION AND EXHIBIT SHOWCASE**

Governor's Hall IV, Exhibit Hall
Statehouse Convention Center

***New Products and Technology
Showcase Host***

Platinum Sponsor:

Farm Press

Coffee and Beverage Service

Bronze Sponsor:

Food Protection Services

This is your opportunity to hear about innovations
in rice-related technology, products and services.

Presenters as of press time:

Fred Seamon

CME Group

Dickie Edmond

DuPont Crop Protection

John Aubin

John Deere Company

Joy Rogers

Dow AgroSciences

Terry Medley

Case IH

Darryl Loggains

RiceCo, LLC

Perry Nettles

Food Protection Services

Dr. Jennifer Wells

Horizon Ag LLC

Jimmy Johnson

AGROTAIN International

Jake LaRue

Valmont Irrigation

Fred Cathcart

Valley View Agri

Roger Murdock

Lexion/Claas

Dennis Carman

White River Irrigation District

Michael Creed

RiceOnline.com

Dr. Brian Ottis

RiceTec, Inc.

Jake Ridenour

Farm Works Software

Please visit these and all the conference exhibitors at their booths after the session and throughout the conference.

9 a.m. to Noon

MORNING GENERAL SESSION

Statehouse Ballroom

Statehouse Convention Center

9 a.m. to 9:35 a.m.

WELCOME AND OPENING REMARKS

James Warshaw

Chairman, USA Rice Federation

HOST STATE WELCOME – ARKANSAS

Thomas Hoskyn
Chairman, USA Rice Producers' Group

HOST STATE SPEAKER

The Honorable Blanche Lincoln
United States Senator, Arkansas

9:35 a.m. to 10:45 a.m.

FEATURED SPEAKER
WORLD ECONOMIC CRISIS – IMPACT
ON AGRICULTURE

Richard A. Brock

Owner and President, Brock Associates

Brock will address the impact the financial crisis will have on commodity prices, farming and agribusiness. Where is the grain market headed? What marketing tools and strategies will work? Brock Associates is an agricultural marketing advisory service. Brock is also the publisher of *The Brock Report*. His firm manages grain sales for more than 400,000 acres throughout the United States. Brock writes a monthly column for two agriculture magazines and appears regularly on both the *Ag Day* television show and *U.S. Farm Report*.

10:45 a.m. to 11 a.m.

COFFEE AND BEVERAGE BREAK –

Governor's IV – Exhibit Hall

Bronze Sponsor:

Rice Belt Warehouse Inc.

11 a.m. to 11:15 a.m.

SPECIAL RECOGNITION

11:15 a.m. to Noon

WASHINGTON INSIDER'S VIEW

Jim Wiesemeyer
Vice President, Informa Economics
Washington Bureau

Noon to 1:15 p.m.

RICE AWARDS LUNCHEON

Statehouse Ballroom
Statehouse Convention Center

Silver Sponsors:

Syngenta
John Deere Company

2008 RICE AWARDS

Farmer of the Year Award

Industry Award

Lifetime Achievement Award

The 2008 Rice Awards are sponsored by Syngenta, *Rice Farming* magazine and the USA Rice Federation. Carroll Smith, Editor, *Rice Farming Magazine*, will make the presentations.

**National Rice Month Scholarship
Grand Prize Presentation**

This program is sponsored by the USA Rice Federation. USA Rice Federation President and CEO Betsy Ward will make the presentation.

Grown in the USA Program Recognition

USA Rice Council Chairman Clarence Berken will make the presentation.

**Special Presentation Honoring "The
Official Grain of the State of Arkansas"**

Arkansas Rice Council President Robert Petter will make the presentation.

**Rice Leadership Development Program
Announcement**

This program is sponsored by John Deere Company and Syngenta. Rice Foundation Chairman Marvin Hare will make the announcement.

1:30 p.m. to 5 p.m.

GUEST EVENT: Little Rock Landmarks
(Meet in Peabody lobby at 1:15 p.m.)

1:30 p.m. to 5:15 p.m.

AFTERNOON GENERAL SESSION

Statehouse Ballroom
Statehouse Convention Center

1:30 p.m. to 2:05 p.m.

**DOMESTIC AND INTERNATIONAL RICE
SITUATION AND OUTLOOK**

Nathan W. Childs
Senior Rice Market Analyst
Economic Research Service
U.S. Department of Agriculture

**ANNUAL STATE PRODUCTION
OUTLOOK REPORTS**

Extension representatives from each of the major rice-producing states will provide timely reports and outlooks.

2:05 p.m. to 2:15 p.m.

ARKANSAS (University of Arkansas)
Bobby Coats

2:15 p.m. to 2:25 p.m.

CALIFORNIA (University of California-Davis)
Christopher A. Greer

2:25 p.m. to 2:35 p.m.

LOUISIANA
(Louisiana State University AgCenter)
Johnny Saichuck

2:35 p.m. to 2:45 p.m.

MISSISSIPPI (Mississippi State University)
Nathan Buehring

MONDAY, DECEMBER 8, 2008 continued

2:45 p.m. to 2:55 p.m.

MISSOURI (SE Missouri State University)
Donn Beighley

2:55 p.m. to 3:05 p.m.

TEXAS (Texas A&M University)
Larry Falconer

3:05 p.m. to 3:15 p.m.

AFTERNOON COFFEE AND BEVERAGE BREAK

Bronze Sponsor:

Case IH

3:15 p.m. to 5:15 p.m.

SPECIAL SESSION FARM BILL IMPLEMENTATION AND IMPLICATIONS FOR RICE

The 2008 Farm Bill resulted in some significant changes in key areas of farm policy. This panel will provide a detailed look at the implications producers can expect in 2009 and beyond due to the new payment limitation, eligibility, and adjusted gross income provisions of the 2008 Farm Bill. Hear perspectives from the USDA's Farm Service Agency, farm program attorneys, and a CPA. These individuals can help answer your questions as you prepare to operate your farm under the new program rules that take effect in 2009.

MODERATOR:

Larry Combest
Partner — Combest/Sell and Associates, LLC

SPEAKER PANEL:

Teresa Lasseter
Administrator
Farm Service Agency
U.S. Department of Agriculture

MONDAY, DECEMBER 8, 2008 *continued*

Renee Hubbard, CPA
Principal, Jackson Thornton

David Bridgforth
Partner
Ramsay, Bridgforth, Harrelson and Starling LLP

Tim Kelleher
Owner and Partner
Kelleher and Olivera LLP

5:15 p.m.

ANNOUNCEMENTS AND ADJOURN

6 p.m. to 7 p.m.

USA RICE OUTLOOK ANNUAL CONFERENCE RECEPTION

Governor's Hall IV — Exhibit Hall
Statehouse Convention Center

Platinum Sponsors:

Dow AgroSciences
Anheuser-Busch, Inc.

TUESDAY, DECEMBER 9, 2008

7:30 a.m. to 11 a.m.

CONTINENTAL BREAKFAST

Governor's Hall IV — Exhibit Hall
Statehouse Convention Center

Bronze Sponsor:

Trinidad Benham Corporation

Tuesday Morning Coffee and Beverage Service

Bronze Sponsor:

FMC Corporation

7:30 a.m. to 8 a.m.

“EARLY BIRD” SESSION

Statehouse Ballroom
Statehouse Convention Center

“CONSERVATION IN RICELANDS OF NORTH AMERICA”

A joint research publication on conservation benefits of ricelands was produced by The Rice Foundation and Ducks Unlimited, Inc. Twelve authors and 16 technical reviewers pulled together the “state of our knowledge” on the subject during this multi-year endeavor. Highlights on findings and the future direction of research and extension education will be discussed.

SPEAKER:

Scott Manley
Ducks Unlimited, Inc.

8 a.m. to 11:15 a.m.

MORNING GENERAL SESSION

Statehouse Ballroom
Statehouse Convention Center

8 a.m. to 9 a.m.

2009 AGRICULTURAL CREDIT OUTLOOK PANEL

Given the substantial uncertainty and risk generated by the recent financial crisis, what should the agricultural industry expect when it comes time to finance next year’s crop production? Will the financial crisis spill over to rural America and the lenders that finance agriculture? Hear perspectives and the outlook for next year from three panelists that represent the lending organizations providing more than 80 percent of the financing to U.S. agriculture.

SPEAKER PANEL:

Seaver Sowers
Senior Federal Legislative Representative
American Bankers Association

Greg Cole
President and CEO
AgHeritage Farm Credit Services

Mark Scanlan
Vice President
Office of Agriculture and Rural Policy
Independent Community Bankers of America

9:00 a.m. to 9:30 a.m.

FERTILIZER SITUATION AND OUTLOOK

With a very active fertilizer market generating constantly escalating prices much of this year, there is a strong interest in what is happening in the market, why, and what could happen next year. Learn firsthand about the dynamics that have been and are affecting the market and hear an outlook from the President of companies that are very engaged in both the domestic and international fertilizer markets and who contributes frequently to agricultural publications.

SPEAKER:

Mike Stegmann
President
Lange-Stegmann Co. and
AGROTAIN International

9:30 a.m. to 10 a.m.

THE WEEDS ARE TALKING-IS ANYBODY LISTENING?

This session will discuss potential developing weed problems, weed resistance to herbicides, managing weed resistance with current technology and the ultimate need for new weed control technology in rice.

SPEAKER:

Ford Baldwin
Practical Weed Consultants, LLC

TUESDAY, DECEMBER 9, 2008 continued

10:00 a.m. to 11:10 a.m.

CUTTING-EDGE RICE RESEARCH

Researchers from each of the major rice-producing states will provide timely reports. This session also includes a national research update from the Dale Bumpers National Rice Research Center.

10 a.m. to 10:10 a.m.

ARKANSAS (University of Arkansas)

Christopher Deren

10:10 a.m. to 10:20 a.m.

CALIFORNIA (University of California-Davis)

Christopher A. Greer

10:20 a.m. to 10:30 a.m.

LOUISIANA (Louisiana State University AgCenter)

Steve D. Linscombe

10:30 a.m. to 10:40 a.m.

MISSISSIPPI (Mississippi State University)

Tim Walker

10:40 a.m. to 10:50 a.m.

MISSOURI (SE Missouri State University)

Donn Beighley

10:50 a.m. to 11 a.m.

TEXAS (Texas A&M University)

Ted Wilson

11 a.m. to 11:10 a.m.

NATIONAL RESEARCH

(Dale Bumpers National Rice Research Center)

Anna McClung

11:15 a.m.

**2008 USA RICE OUTLOOK CONFERENCE
ADJOURNS**

**2008 USA RICE OUTLOOK CONFERENCE
PLATINUM SPONSOR**



**2008 USA RICE OUTLOOK CONFERENCE
PLATINUM SPONSOR**



Bayer CropScience

**2008 USA RICE OUTLOOK CONFERENCE
PLATINUM SPONSOR**



**2008 USA RICE OUTLOOK CONFERENCE
PLATINUM SPONSOR**



**FARM
PRESS**

**2008 USA RICE OUTLOOK CONFERENCE
SILVER SPONSORS**



FARM CREDIT MIDSOUTH, ACA
At the heart of a growing America™

AGROTAIN[®]

Improved Nitrogen Efficiency



JOHN DEERE

KB
X INC.

**2008 USA RICE OUTLOOK CONFERENCE
SILVER SPONSORS**



syngenta

The Syngenta logo is displayed in a bold, lowercase, sans-serif font. A single leaf icon is positioned above the letter 'g'. The logo is centered within a rectangular frame that has small square notches at each corner.

VALLEY 

The Valley logo features the word "VALLEY" in a bold, uppercase, sans-serif font. To the right of the text is a stylized logo symbol consisting of three horizontal lines of varying lengths, with the top line being the longest and the bottom line the shortest, all connected by a vertical line on the right side.

Precision Irrigation Made Easy®

SAVE THE DATE

2009 USA Rice Outlook Conference

December 9-11, 2009
(Wednesday-Friday)

New Orleans Marriott
New Orleans, Louisiana

FOR MORE INFORMATION

Contact the USA Rice Federation
(703) 236-1447
www.usarice.com



Members:

USA Rice Council • USA Rice Producers' Group
USA Rice Millers' Association • USA Rice Merchants' Association

Mission Statement

USA Rice Federation is the global advocate for all segments of the U.S. rice industry with a mission to promote and protect the interests of producers, millers, merchants and allied businesses.

SCHEDULE-AT-A-GLANCE

Times may be adjusted

Saturday, Dec. 6, 2008

1 p.m. to 5 p.m. REGISTRATION

Sunday, Dec. 7, 2008

7:30 a.m. to 5:30 p.m. REGISTRATION

2 p.m. to 4:30 p.m. GUEST EVENT: RICE "VIP" CULINARY EVENT AT THE CAPITAL HOTEL

5:30 p.m. to 6:30 p.m. GRAND OPENING RECEPTION & EXHIBIT HALL OPENING

Monday, Dec. 8, 2008

7:15 a.m. to 6 p.m. REGISTRATION

7:15 a.m. to 7 p.m. EXHIBIT HALL OPEN

7:30 a.m. to 8:55 a.m. NEW PRODUCTS & TECHNOLOGY BREAKFAST AND EXHIBITOR SHOWCASE

9 a.m. to Noon MORNING GENERAL SESSION

Noon to 1:15 p.m. RICE AWARDS LUNCHEON

1:30 p.m. to 5 p.m. GUEST EVENT: LITTLE ROCK LANDMARKS

1:30 p.m. to 5:15 p.m. AFTERNOON GENERAL SESSION

6 p.m. to 7 p.m. ANNUAL USA RICE OUTLOOK CONFERENCE RECEPTION

Tuesday, Dec. 9, 2008

7:30 a.m. to 11 a.m. REGISTRATION & EXHIBIT HALL OPEN

7:30 a.m. to 8 a.m. "EARLY BIRD" SESSION

8 a.m. to 11:15 a.m. MORNING GENERAL SESSION

11:15 a.m. 2008 USA RICE OUTLOOK CONFERENCE ADJOURNS